

SESSION 1

This session contains 30 multiple-choice questions. Fill in the circle for your answer to each multiple-choice question.

You may use a protractor and a ruler during this session. You may **not** use a calculator during this session.

SAMPLE

Directions: Read each problem. Then fill in the circle of the best answer.

- 1** Lorraine added these fractions together.

$$\frac{3}{4} + \frac{1}{4}$$

Which expression and picture also represent the sum of this expression?



$$\frac{1}{4} + \frac{1}{4} + \frac{1}{4} + \frac{1}{4}$$



$$\frac{2}{4} + \frac{1}{4}$$



$$\frac{1}{4} + \frac{1}{4} + \frac{1}{4} + \frac{1}{4}$$



$$\frac{1}{4} + \frac{1}{4} + \frac{1}{4}$$

- 2** Elijah created the area model below to find a product.

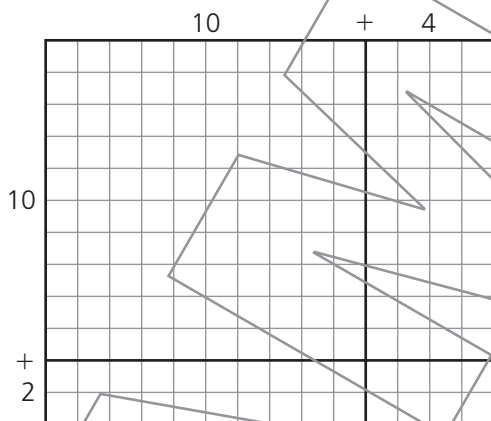

Which value is Elijah trying to find?

- (A) 10×4
(B) 10×10
(C) 14×12
(D) 2×10

SESSION 2

This session contains eight multiple-choice questions, six short constructed-response items, and one extended constructed-response item. Fill in the circle for your answer to each multiple-choice question. Write your answers for the constructed-response items in the spaces provided.

You may use a protractor and a ruler during this session. You may **not** use a calculator during this session.

SAMPLE

33

A group performs a theater puppet show three times one day. The chart below shows how many students went to each show.

Time of Day	Number of Students
Morning	347
Afternoon	224
Evening	305

Rounded to the nearest ten, about how many students went to all three shows?

- (A) 780
- (B) 870
- (C) 880
- (D) 900

34

During a rainstorm, Aaron put some containers outside to collect rain. Each container can hold 1,000 milliliters of liquid. He collected 3 full containers of rain. What is the total amount of rain, in milliliters, that Aaron collected?

- (A) 3 milliliters
- (B) 30 milliliters
- (C) 300 milliliters
- (D) 3,000 milliliters

44

The diagram below shows a meeting room.

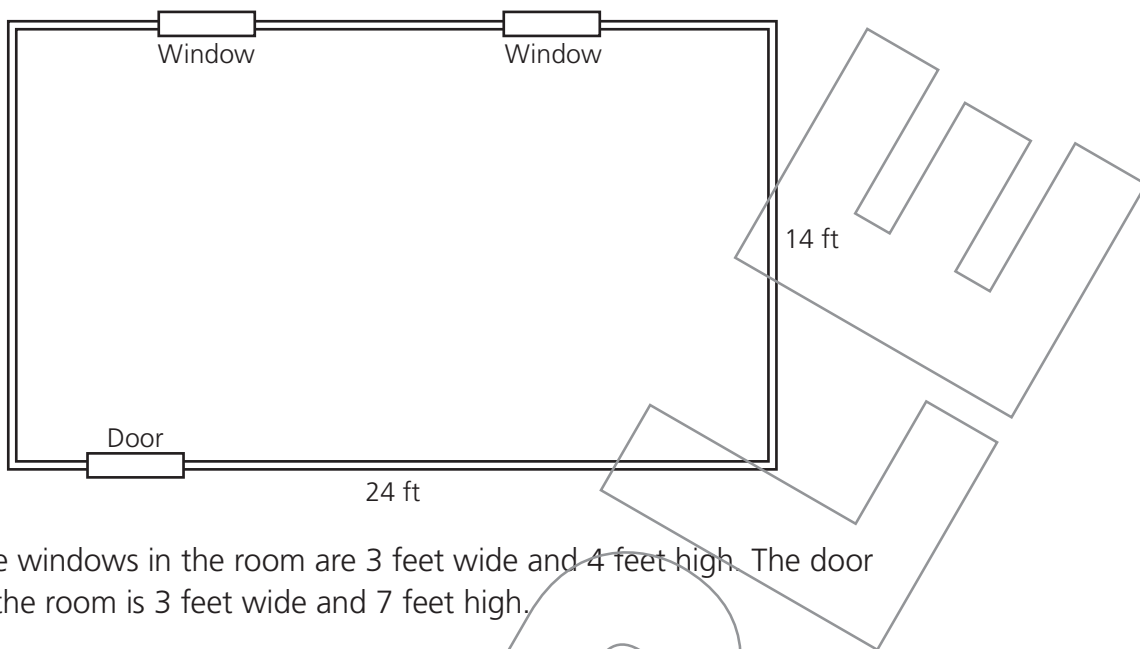

The windows in the room are 3 feet wide and 4 feet high. The door in the room is 3 feet wide and 7 feet high.

Part A: A painter is painting a border around the top of the room and around each window. What is the total length, in feet, of the border?

Show your work.

Answer: _____ feet

Part B: New carpet is being put in the meeting room. How many square feet of carpet are needed?

Answer: _____ square feet

45

Some friends are playing a card game. Heather has 8 times as many cards as Alejandro. Heather has a total of 24 cards.

Part A: Write a number sentence to show how to find the number of cards that Alejandro has.

Answer: _____

Part B: Alejandro and Heather are playing as a team. They combine their cards. Then they divide them into 4 even piles. How many cards are left?

Show your work.

Answer: _____ cards

Part C: To find a final score, the players multiply the number of cards in one pile by 643. Explain how Alejandro and Heather can use estimation to find their final score.
